

HISTORIC RESOURCES INVENTORY

Ser. No. _____
HABS _____ HAER _____ NR 4D SHL _____ Loc _____
UTM: A 11-298700/3786820 B 11-298670/3786040
C 11-298550/3786050 D 11-298580/3786830

IDENTIFICATION

1. Common name: G Street
2. Historic name: Walter H. Lathrop Subdivision
3. Street or rural address: 400 South G Street to 100 North G Street
City Oxnard Zip 93030 County Ventura
4. Parcel number: See individual listings
5. Present Owner: Multiple Address: _____
City _____ Zip _____ Ownership is: Public _____ Private X
Single to multi-
6. Present Use: family residences Original use: same

DESCRIPTION

Combination of California and Craftsman bungalow

- 7a. Architectural style: houses, Period Revival and Mediterranean styles
- 7b. Briefly describe the present *physical description* of the site or structure and describe any major alterations from its original condition:

Similar to F Street in many respects although developed a few years later, G Street also features wide tree-lined streets, raised lawns and low walls, and alleys with rear parking. Lots are mostly 50' X 140' and some have additional dwellings in the rear. Houses maintain even setbacks and are well landscaped with many mature trees including palms, pines, cedars and other varieties. The majority of houses maintain their original style with very few alterations.

Attach Photo(s) Here

8. Construction date: 1913-1950
Estimated X Factual _____
9. Architect Unknown except for a few
10. Builder Adolph Schroeder, Paul Staples and others
11. Approx. property size (in feet)
Frontage 50' Depth 140
or approx. acreage _____
12. Date(s) of enclosed photograph(s)
March 1981

County of Ventura
May 9, 2022
Cultural Heritage Board Meeting
Item 7a
Exhibit 3 - Survey Evaluation

13. Condition: Excellent Good Fair Deteriorated _____ No longer in existence _____
14. Alterations: A few alterations exist and are listed individually
15. Surroundings: (Check more than one if necessary) Open land _____ Scattered buildings _____ Densely built-up
Residential Industrial _____ Commercial _____ Other: _____
16. Threats to site: None known Private development _____ Zoning _____ Vandalism _____
Public Works project _____ Other: _____
17. Is the structure: On its original site? Moved? _____ Unknown? _____
18. Related features: Separate garages, small dwellings in rear on alley.

SIGNIFICANCE

19. Briefly state historical and/or architectural importance (include dates, events, and persons associated with the site.)
The Walter H. Lathrop Tract was subdivided in 1913 by Lathrop, an early Oxnard booster, real estate salesman and City Trustee. His own house was located at 355 South G Street. The west side of the 300 block of G Street contains unusually wide lots (75' X 140') and the houses are quite large in comparison to those on the rest of G Street. Early builders on G Street were Adolph Schroeder, Paul Staples, Edward Abplanalp and others. The houses documented in this neighborhood belonged to both the upper class and working class families. The majority of houses were built in the 1920's and 1930's. The four blocks of G Street are all residential except for the Brittell School at the north end of the street. Houses are uniform in scale and street is wide with parkways lined with trees.

20. Main theme of the historic resource: (If more than one is checked, number in order of importance.)
Architecture Arts & Leisure _____
Economic/Industrial _____ Exploration/Settlement _____
Government _____ Military _____
Religion _____ Social/Education _____
21. Sources (List books, documents, surveys, personal interviews and their dates). Assessor's Records 1911-1924; Sanborn Maps 1912-1929; City Directories 1912-13-1941. Personal interviews - Maud Higbee, Emily Ritchen, April 20, 1981; Misc. records, Book 3 & 5.
22. Date form prepared April 24, 1981
By (name) Judy Triem
Organization Cultural Heritage Board
Address: 800 South Victoria Ave.
City Ventura, CA Zip 93009
Phone: (805) 654-3968
Marge Simpson, Madeline Miedema

Locational sketch map (draw and label site and surrounding streets, roads, and prominent landmarks):

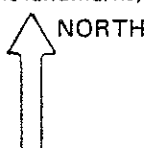

100 Block North to 400 Block South G Street

All of the structures are contributing in this area. The asterisks by each address represent the most outstanding examples.

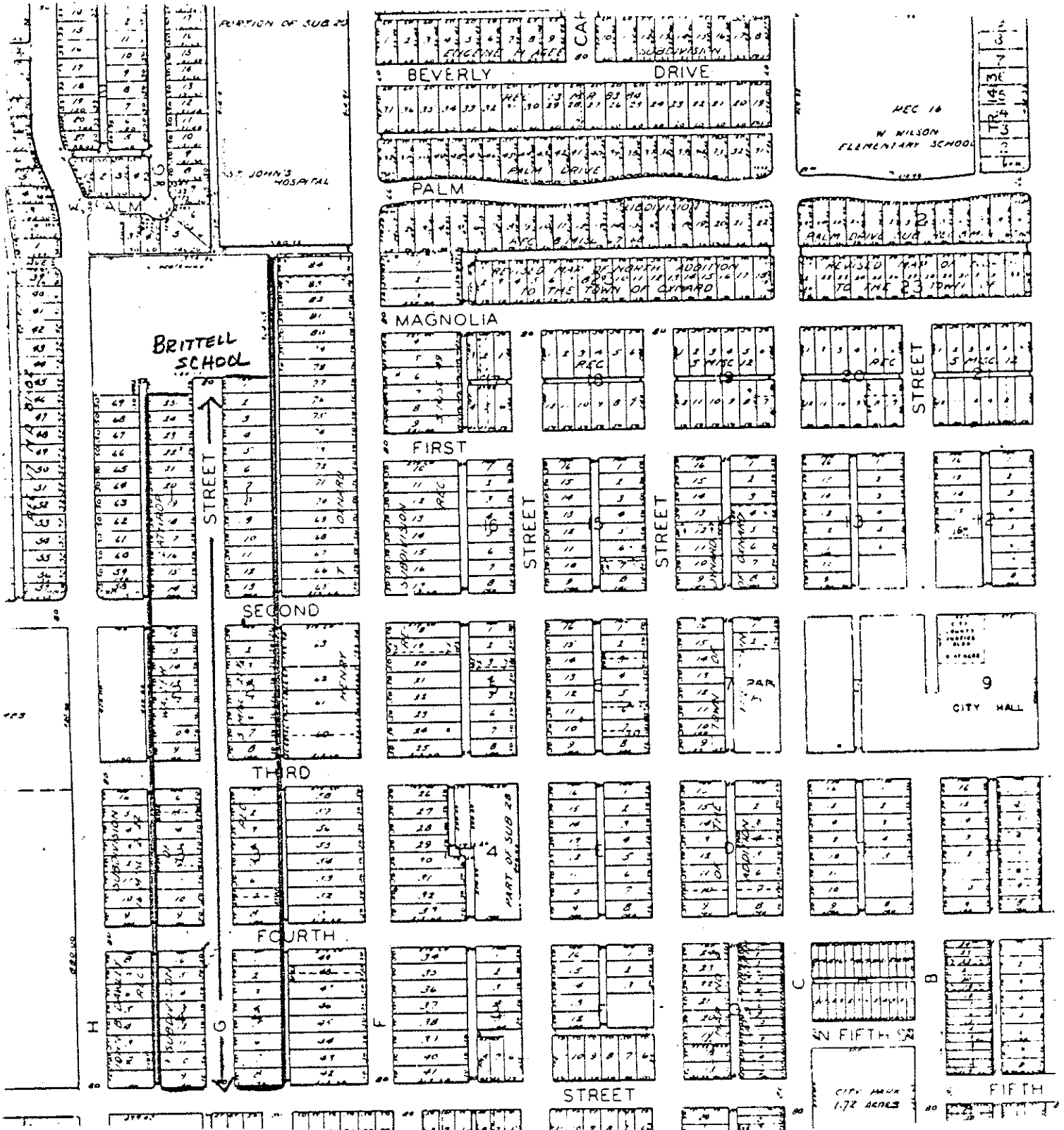

100 Block G Street -- west side

155 South G Street (on separate form at end of report)

One of the few houses designed by Los Angeles architect, Homer Glidden in 1914, the Henry Levy house is an outstanding example of a three story Craftsman shingle style house with Tudor influences. Henry Levy, brother of Achille Levy (founder of Bank of A. Levy), was a bean broker and shipper. The house is very spacious, spreading over three lots, with many of the old trees, gardens and pond still on the property. The second story is shingled whereas the first story has medium clapboard siding. Wood trim under the front gable and roof shingles resembling thatching suggest a Tudor influence. Notched beams under the eaves, the use of brick on porch columns and chimney, lend a Craftsman feeling. The interior features the extensive use of wood (oak) and the fireplace tiles resemble the Batchelder tiles used in many Craftsman houses in Southern California. House remains virtually unchanged. The new owners have added a stone wall and wrought iron fence around the property. A small house, probably for servants, is at the rear.

135 South G Street

What was once a stucco Provincial style house has recently had additions of wood strips placed across facade which alters its original style. The house was built ca 1924 for Fred C. Snodgrass, salesman.

127 South G Street

Single story residence with U-shaped entrance and narrow clapboard siding. Large two-story stucco residence in rear. Built ca 1924 for John D. Gastl, salesman for A. J. Dingeman.

121 South G Street

Mediterranean style bungalow with triple arched front porch. Built ca 1926 for Harry W. Johnson, Chief of Police and City Tax Collector.

115 South G Street

Built ca 1926 for Irwin M. Lowe, auditor for Ventura Investment Company. Single story Mediterranean style house.

101 South G Street

This Mediterranean style house has an interesting textured surface. A large arched front window contains multi radiating panes that produce a decorative effect. Mature pine tree in front yard.